

MEDICAL OFFICES FOR LEASE
Pad Site for Build-to-Suit
Flower Mound, Texas



- LOT LOCATION:** **2620 Windsor Centre Drive (Lot 4, Block B)**
Located off FM 2499 and Windsor Drive, just northwest of the new Lewisville Medical Center Emergency Care. Great location west of the site for the new Presbyterian Hospital and River Walk Project.
- LEASE RATE:** \$18.00-\$22.00/SF Base and NNNs (\$5.50/SF) plus electric and janitorial
- SIZE:** Will accommodate up to 9,400 SF build-to-suit lease space.
- AVAILABLE:** Immediately

For further information contact: Phyllis Garcia



Vintage Realty

2980 Long Prairie Road, Suite D

Flower Mound, TX 75022

972/355-0669 or Fax 972/355-5477

email: phyllis@vintagerealty.net www.VintageRealty.net

2620 Windsor Centre Drive
Lot 4, Block B

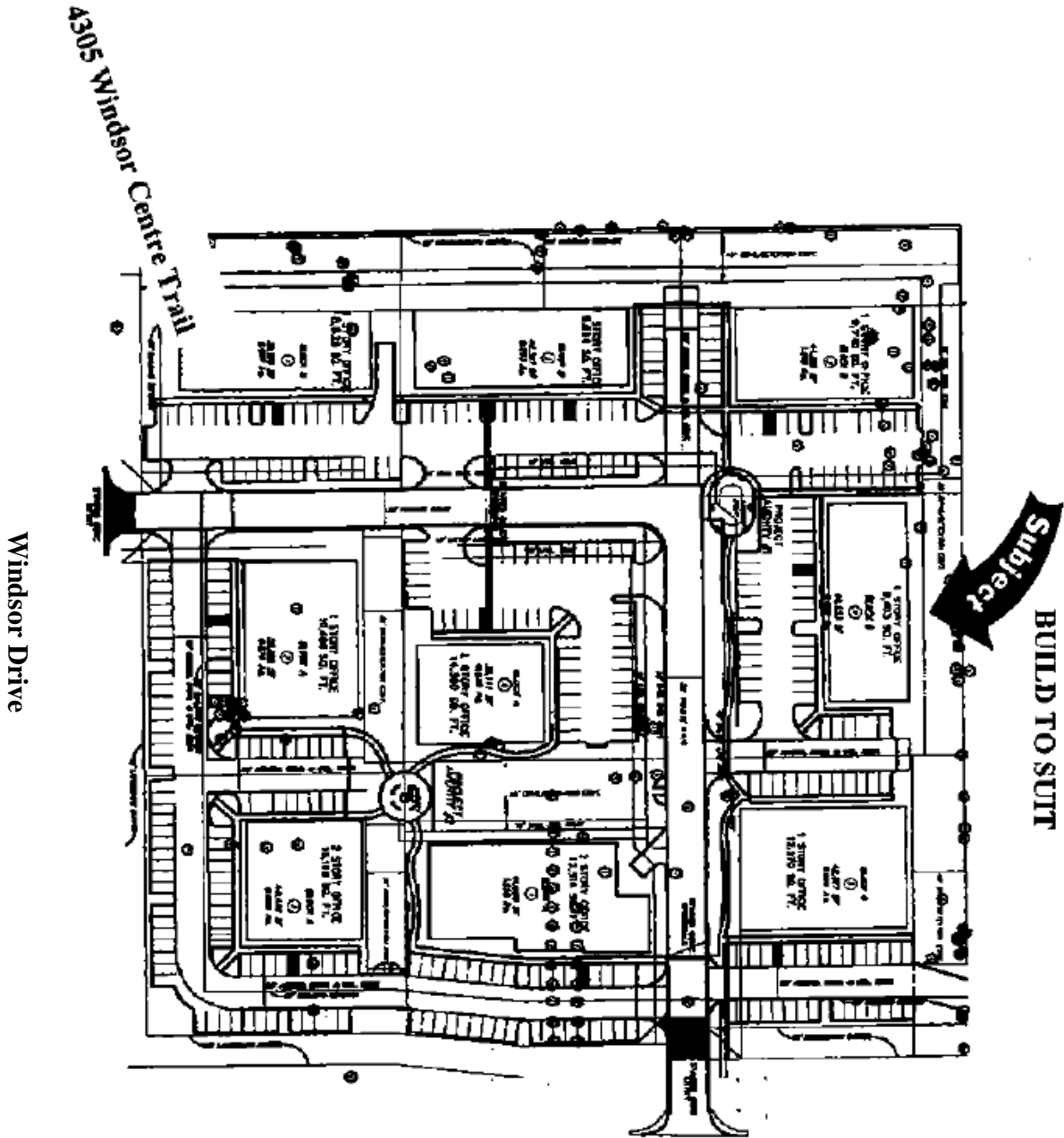

Windsor Drive

4305 Windsor Centre Trail

Long Prairie Road / FM 2499

**2620 Windsor Centre Drive
Flower Mound, TX**

