

# OFFICE SPACE FOR LEASE FLOWER MOUND, TX



- LOCATION:** 2200 Morriss Road, Suite 100; Former medical clinic.  
Easy access to FM 2499 and FM 3040. Located close to neighborhood schools and restaurants.
- SPACE:** 6,692 SF  
Finished medical office which includes: 13 Exam Rooms, 4 Offices, Reception Area, Waiting Room, Nurses' Station, X-Ray Room, Lab and Treatment Rooms.
- LEASE RATE:** \$17/SF Base plus NNNs (\$5.16/SF) and electric
- TI ALLOWANCE:** Negotiable
- AVAILABLE:** Immediately

**For further information contact: Phyllis Garcia**



**Vintage Realty**

2980 Long Praire Road, Suite D

Flower Mound, TX 75022

972/355-0669 or Fax 972/355-5477

Email: [Phyllis@VintageRealty.net](mailto:Phyllis@VintageRealty.net) or Web Site: [www.VintageRealty.net](http://www.VintageRealty.net)

This information is believed to be accurate, but no representation or warranty, express or implied, as to its accuracy or completeness is made by any party. The presentation of this property is submitted subject to errors, omissions, change of price or prior sale or lease, or withdrawal without notice.

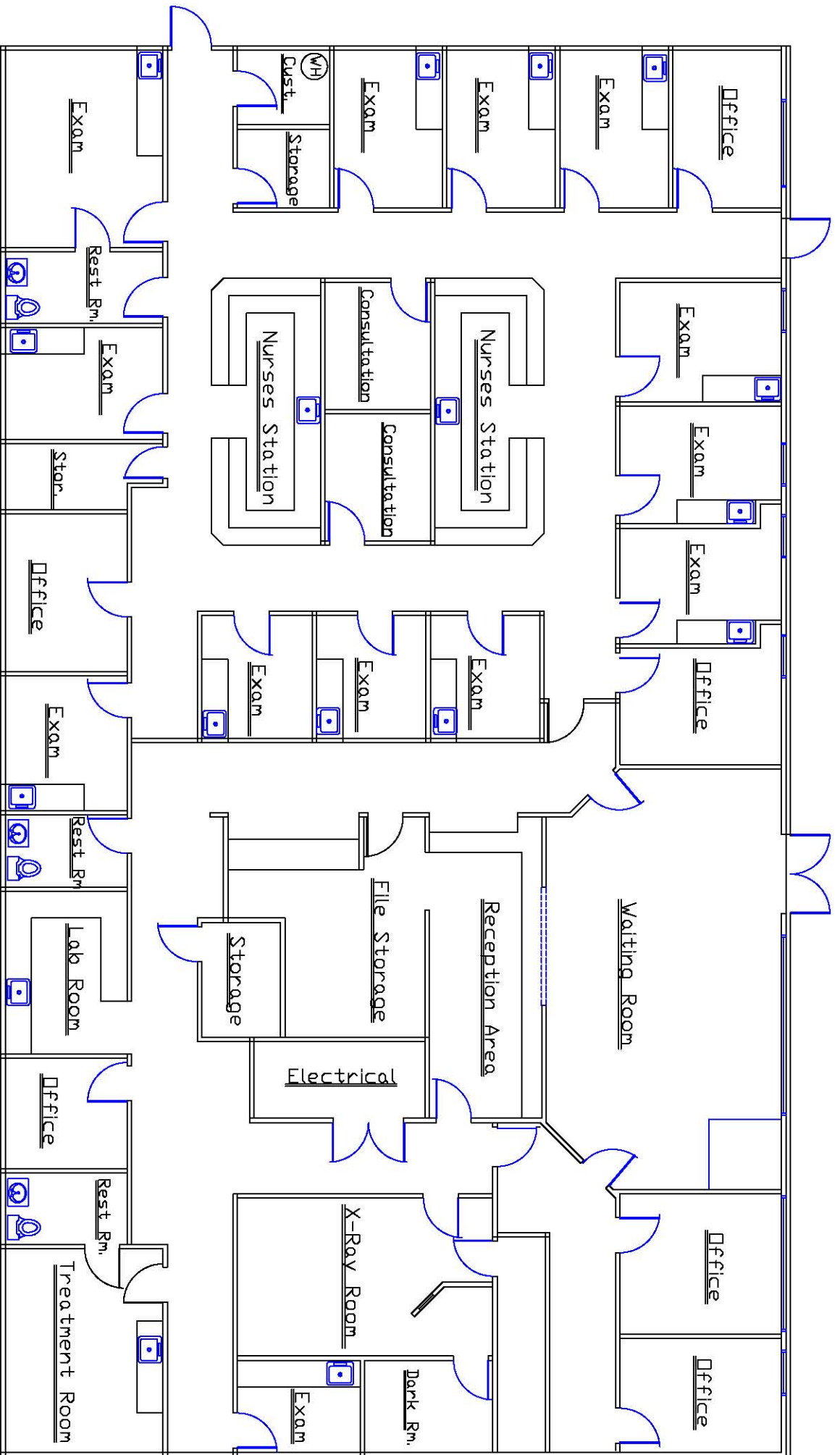

2200 Morriss Road, Suite 100  
 Flower Mound, Texas





# 2200 Morriss Road Flower Mound, TX

